

NEW

The SMC with wire-type fuse-element is the world's first pin terminal type fuse with a robust high-temperature resistant ceramic structure. This fuse has obtained certification from SEMKO, and has been issued a conformity test certificate per the Electrical Appliance and Material Safety Law of Japan.

SMC (Inrush-withstand)

RoHS

Pb

AC250V

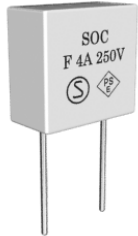

Scale: 2/1

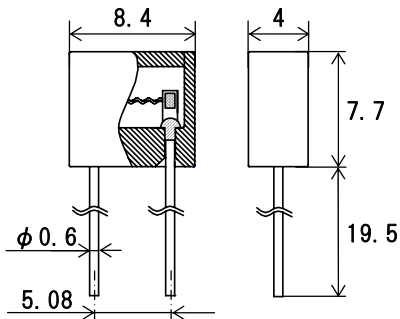

Referential dimensions of mounting holes

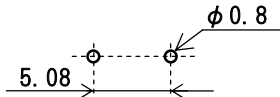

Unit: mm

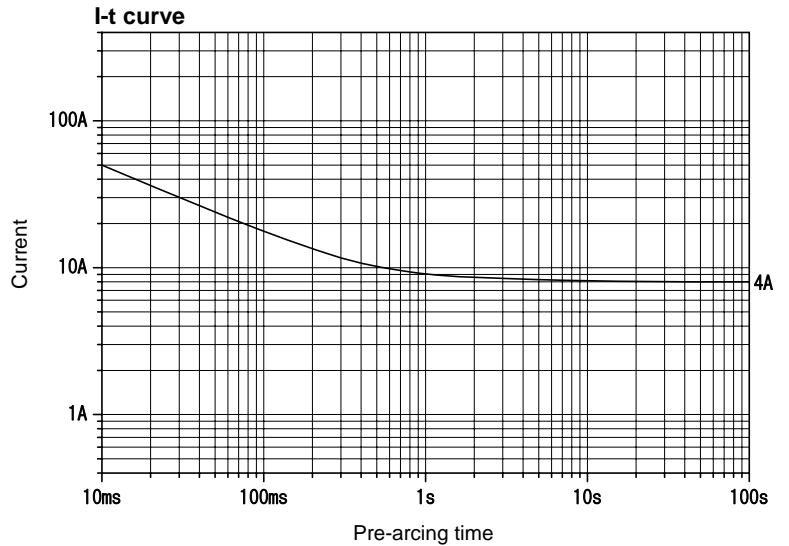

The I-t curve above is based on the average values of measurements obtained under testing conditions specified by our company. The information is for reference purposes only, and is not intended to infer any guarantees of performance.

Rated voltage	Certification	Rated current (I_N)	Rated breaking current		Endurance test	Temp. rise	Pre-arcing time/ current characteristic
AC250V	SEMKO Certified <PS>E JET	4A	40A	PF Over 0.95	*1	*2	*3

*1: After repeating 100 cycles of 1.0 I_N for 1 h and switching-off for 15 min, 1.5 I_N can be passed through the fuse for 1 h or more.

*2: 135 K or less on each part of the fuse when 1.5 I_N is applied for 15 min, and then the current is increased by 0.1 I_N every 15 min until the fuse operates.

*3:

Rated current	2.1 I_N	2.75 I_N	4.0 I_N	10 I_N
4A	Within 30min	0.01s - 3s	0.003s - 0.3s	Within 0.02s